



Dinam LED Limited, Dynamic lighting for colorful life

LED PANEL (600X600)

(Constant-current)

PA-CC3528-N

SECOND GENERATION PRODUCT



## **Dinam LED Limited**

Web: [www.dinamled.com](http://www.dinamled.com)

Email: [info@dinamled.com](mailto:info@dinamled.com)

Phone: +86-755-23020300

Mobile: +86-13600151478

Address: B Building, Chuangfu Industrial Zone, Beihuan Road,

Shiyan Town, Baoan District Shenzhen, China.

# LED Panel

## Features:

- Energy saving up to 50%.even lighting output.
- Wide range of input voltage: AC 100~240V.
- Instant start, no flicking, no humming.
- New high efficiency constant current driver.
- Special circuit design, each group of LEDs work separately, avoiding any problem of lighting output caused or influenced by single faulty LED.
- No RF interference.

## Photo:



## LED panel second generation product features

## 600X600 LED PANEL SPECIFICATIONS

NUMBER	ITEM	DESCRIPTION
1	Input voltage	AC 100~240V
2	Panel Input	DC 55~70V (700 mA)
3	Power consumption	41.65W
4	luminous flux	3466 lm(white) 2440lm(warm white)
5	Color	Warm white White
6	Color temperature	2500~4000k(Warm white) 4000~7000k(White)
7	Life time	>50,000 Hour
8	Operating temperature	-20°C to + 50°C
9	Storage temperature	-30°C to + 60°C
10	Luminosity	>852 Lux(1.2meter, White) >596 Lux(1.2meter, Warm white)
11	Certificates	CE . RoHS
12	Weight	3.8 KGS
13	Size	595X595X10.4 mm
14	Water proof	IP20

Part number	Color	Voltage	Current	Power	Luminous Flux
PA-CC3528-N-W	White	DC 55~70V	700 mA	41.65 W	3466 lm
PA-CC3528-N-WW	Warm white	DC 55~70V	700 mA	41.65 W	2440 lm

## Light Distribution Graph

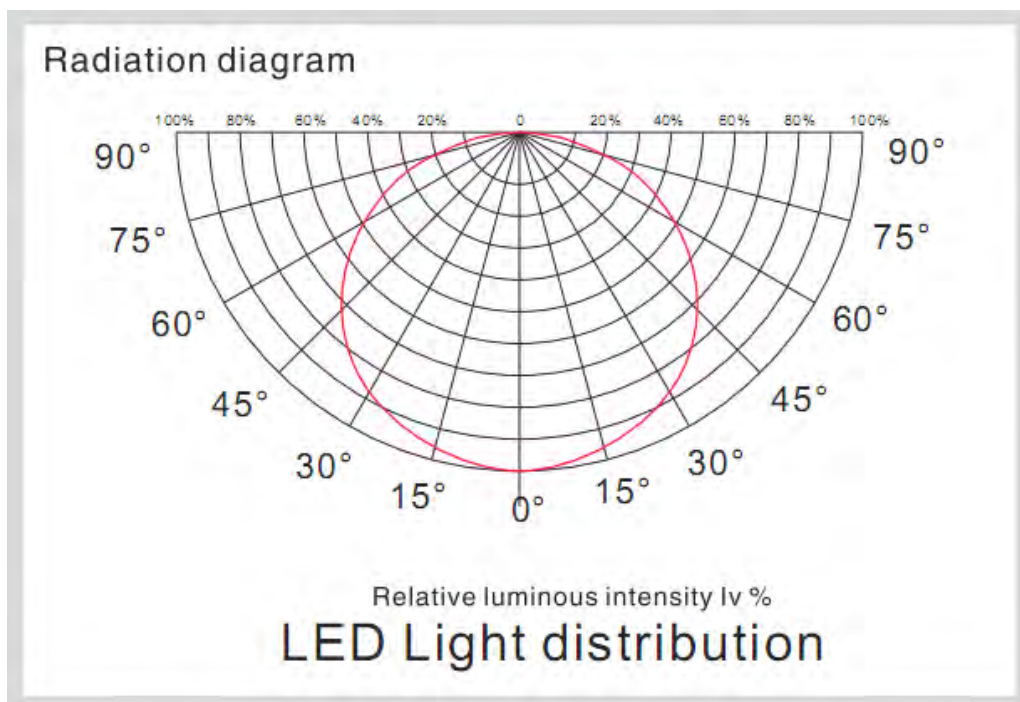

## Illumination Intensity Chart: ( White )

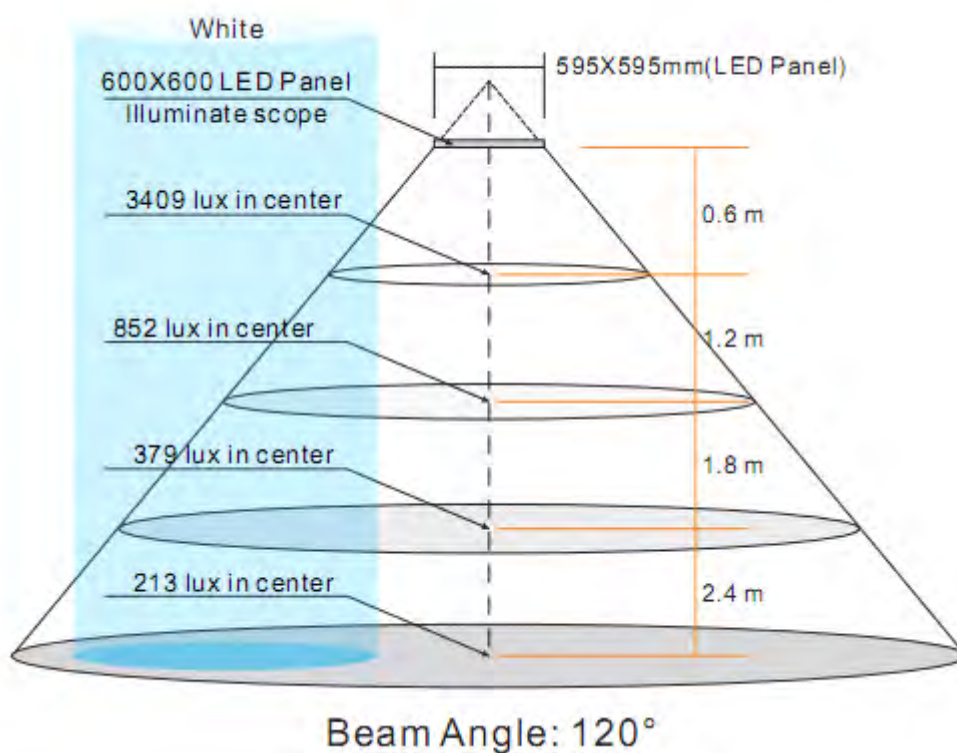

## LED Lumen Attenuation:

Operating time(hours)	Lumen decrease (%)
5,000	2.3
10,000	5.4
20,000	11.5
50,000	25.2

## Panel Size:

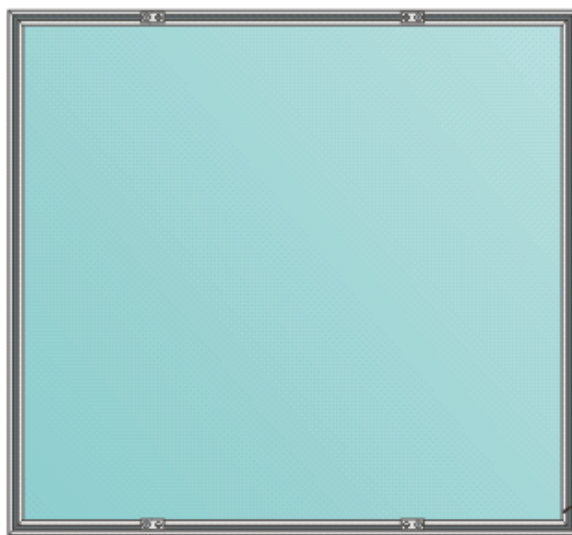
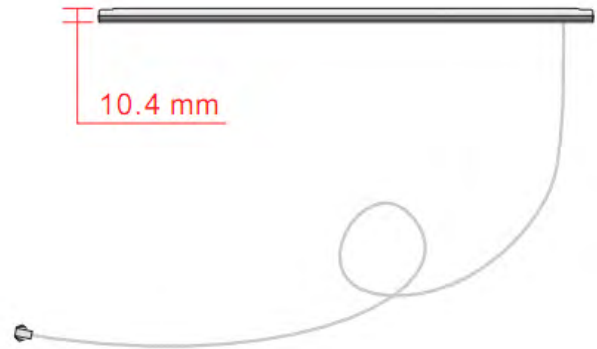
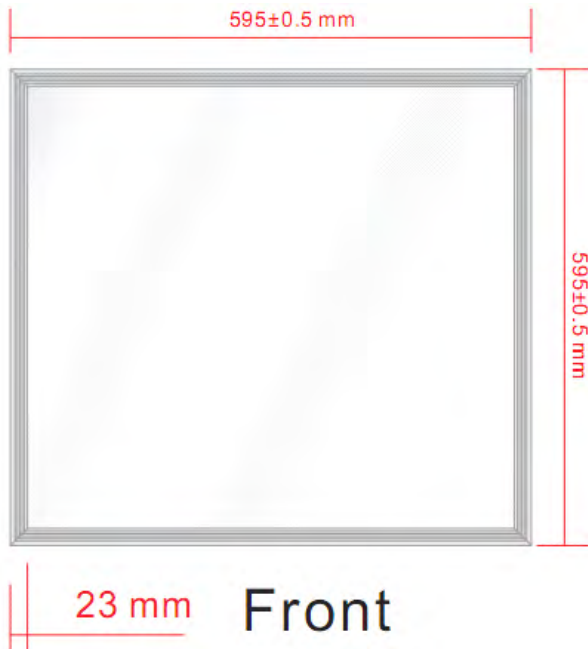

**Back**

All dimension units are in millimeters  $\pm 0.5\text{mm}$

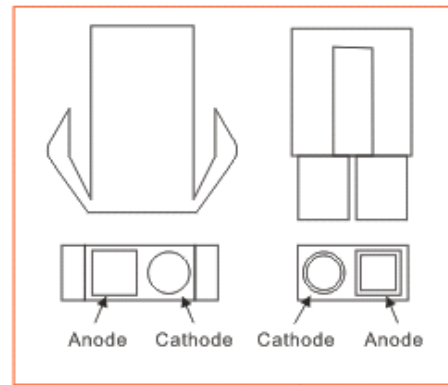

## Packing

Outer carton: 77X68X36 cm

Net weight of each panel: 3.8 KG

Packing Qty: 5 pcs

# Wall installation

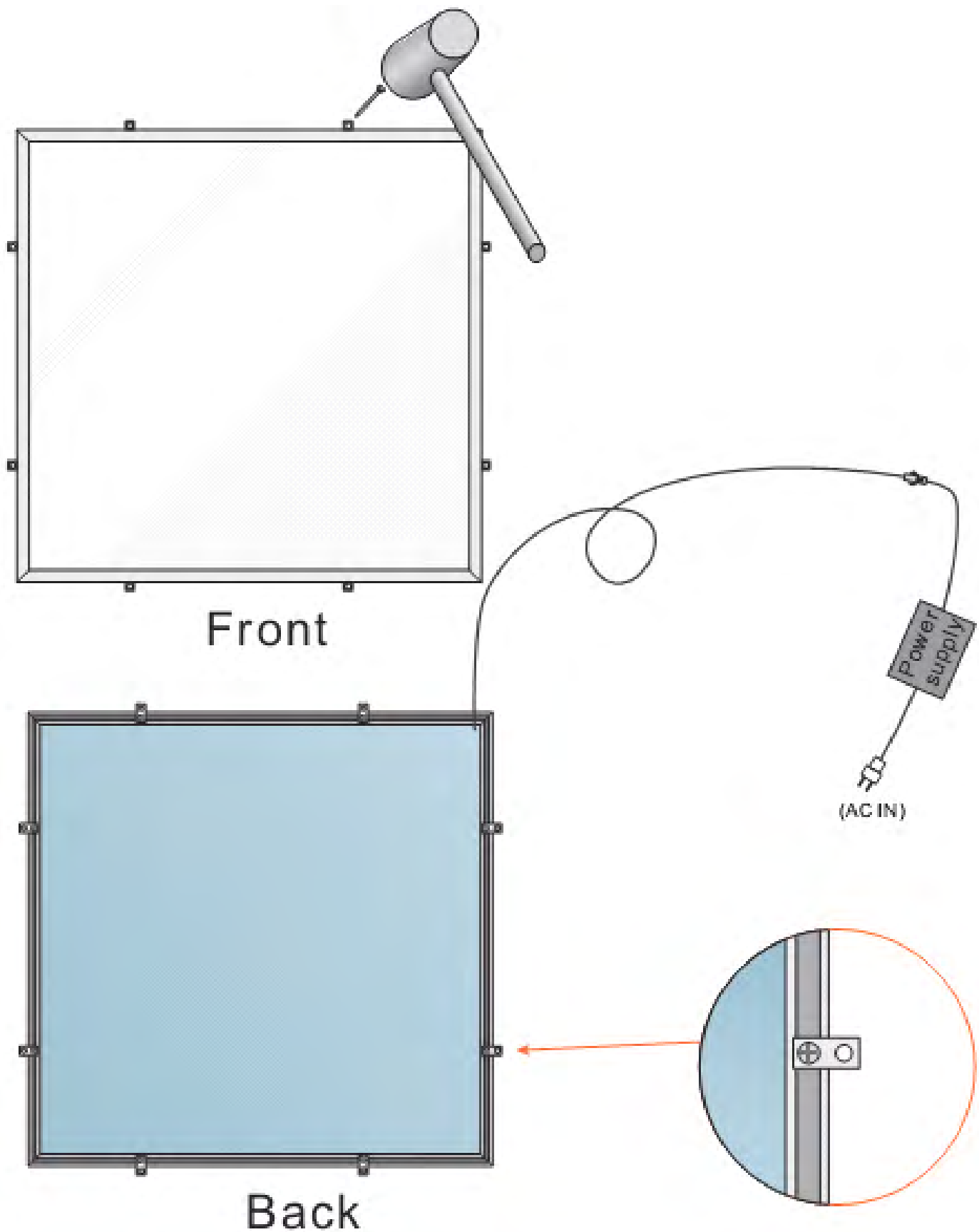

This product is simple and convenient installation. The client may be more reasonable application of the product to fit the scenic spot.

# Suspension installation

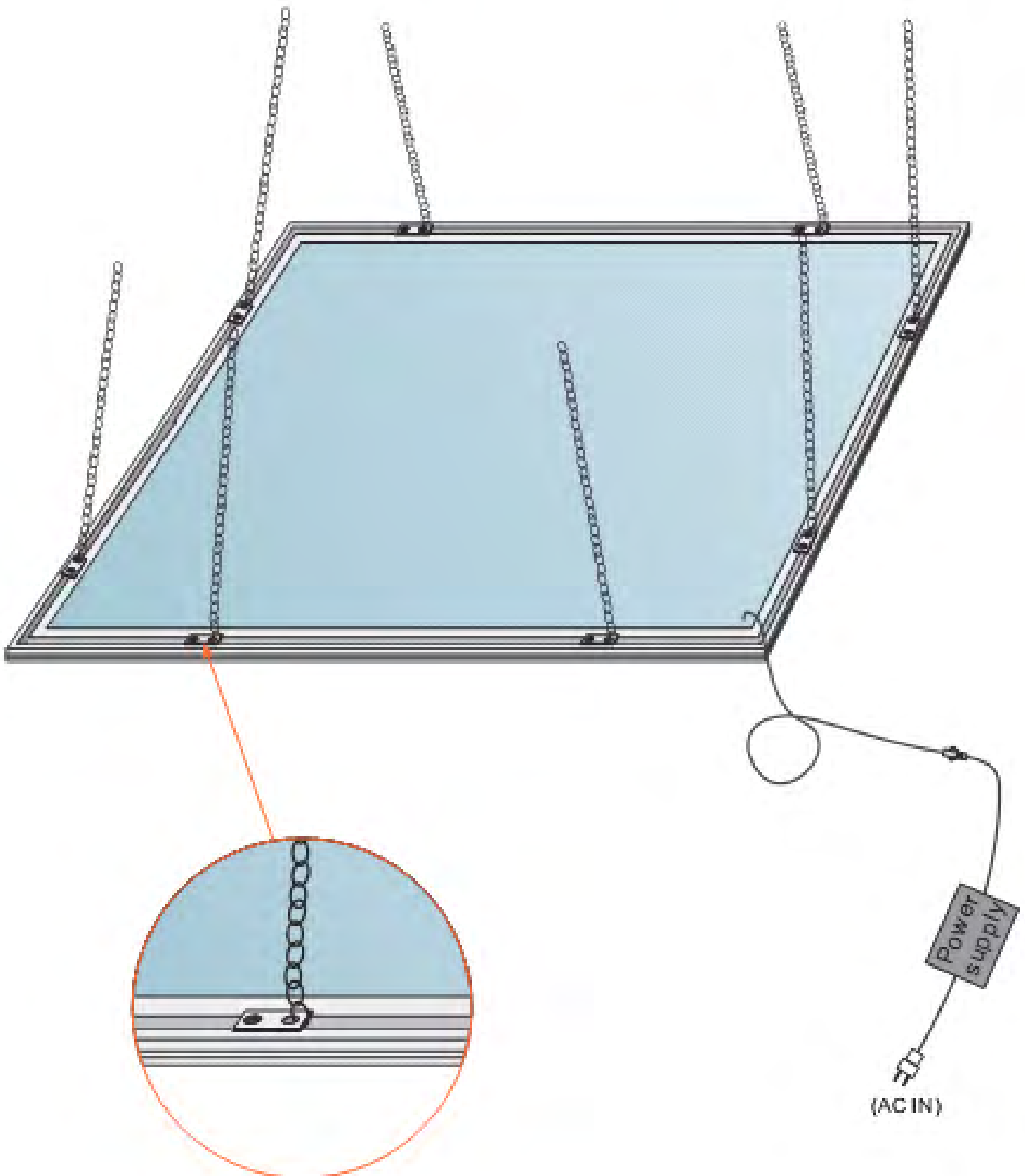

This product is simple and convenient installation. The client may be more reasonable application of the product to fit the scenic spot.

## LED Panel light installing standard configuration:

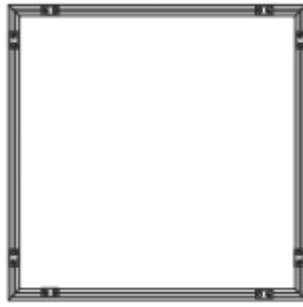

## LED Panel hanging installation:

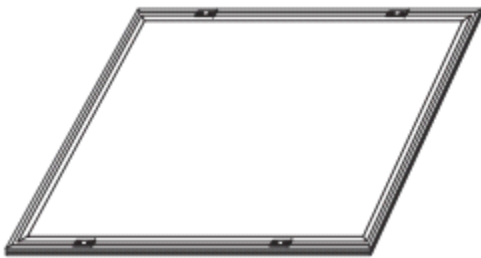

(Step1) LED panel back picture.

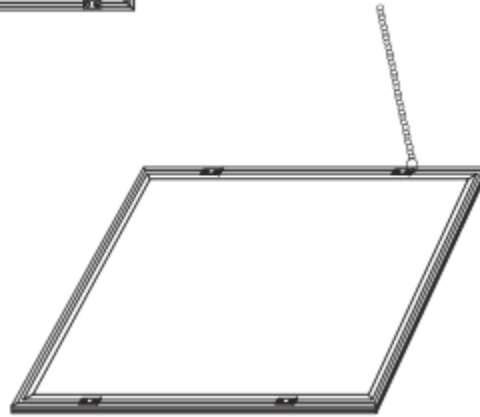

(step 2) Fixing the chains of the accessories to the mounting holes which are in the back of the panel light.

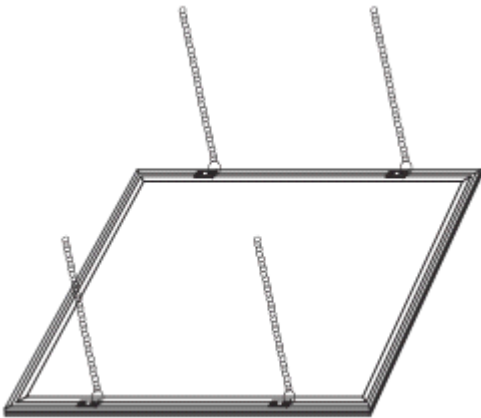

(step 3) Fixed picture.



(step 4) Rendering.

## LED panel hanging installation in wall:

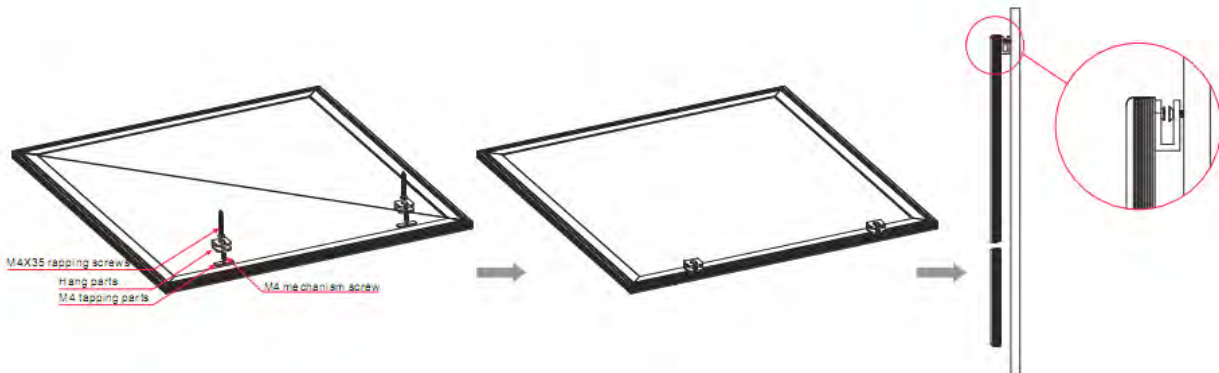

(Step 1) Put the M4 tapping into the sliding chute of panel in the back. Align M4 to the M4 tapping hole, and then fix it with screws.

(Step2) The rendering after fixing to the panel.

(Step3) The rendering after hanging to the wall.

## LED Panel embedding in ceiling installation:

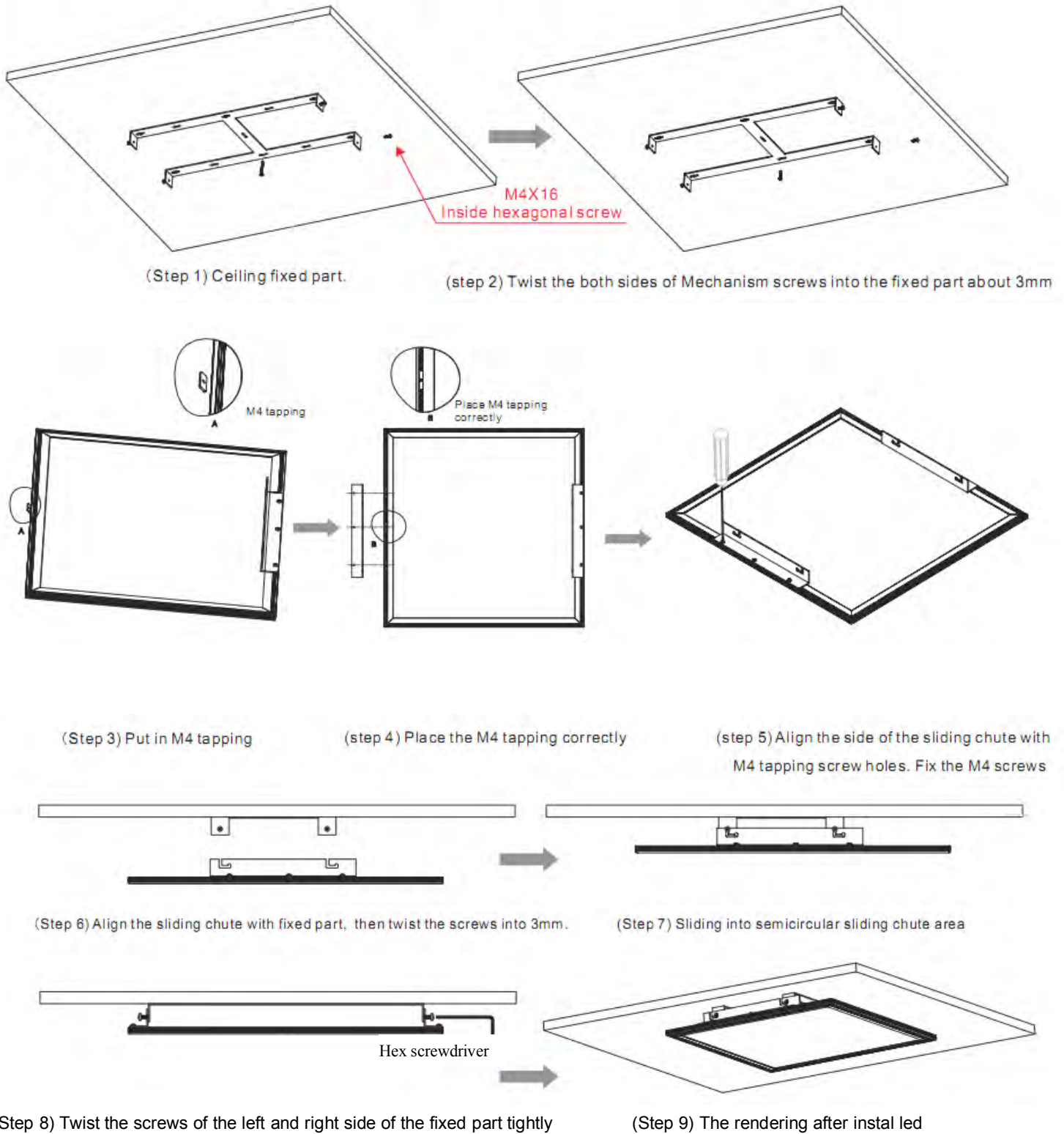

### Application:

The product is energy-saving, the surface is al I made of aluminum production, it has a good cool ing system, easy instal lation, high-grad

appearance , Al I above instal lations are suitable for office, conference room, classroom, shopping mal I, Toi let, restaurant, museum,

exhibition hal I, corridor, I ighting, jewelry, hotel, household I ighting, etc.